

Function and Play value

The See-saw Pump is a very attractive element on water play areas. One child can operate the pump by moving his or her centre of gravity, but also two children can work together for moving the pump to and fro. The holding tube provides safety and helps to coordinate the movement with the others. The pump is also available with a lateral water outlet (special construction) which can be used as water supply for a small channel or a gutter. The combination of the See-saw Pump with a Spraying Head is especially attractive.



This can produce a high or a bubbling water jet, depending on the type. It is funny if the Pump and the Spraying Head are installed without visible connection between each other and the fountain unexpectedly splashes passers-by.

Fundamental characteristics

- can also be used for producing water pressure
- unique and original
- incentive for playing: holding tube, inclined surface
- movement: moving one's centre of gravity

Suitable

- for children from 6 years
- for all water play areas

See-saw Pump
for direct connection to the water main
for water supply from a pond or similar

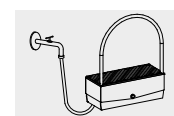

5.18600



5.18700

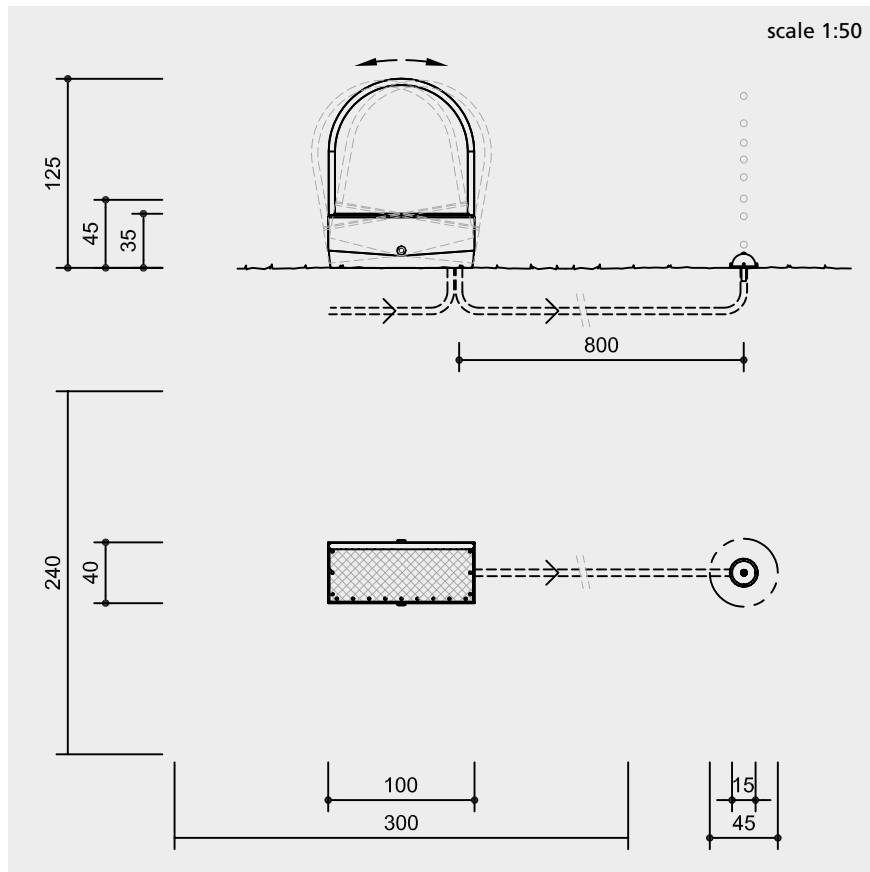

Safety check according to EN 1176

Technical information

housing of the pump completely made of stainless steel, glass bead blasted

tread surface of textured metal sheet

brass bush

for all to and fro movements we use bush bearings which allow for self-lubrication while in use and which can be easily exchanged in case of need



holding tube made of metal tube with a diameter of 42 mm

the type of the See-saw Pump and the water connection depend on the local situation

Dimensions

(small deviations possible)

height	1.25 m
length	1.00 m
width	0.40 m
max. pedestal height	0.45 m
weight	80 kg
required diameter for water supply	1 inch

Components

1 See-saw Pump with foundation frame

Note

For areas with intense solar radiation we offer a wooden deck for the tread surface in order to reduce heating-up see **Order No. 0.57300**.

The following drawings show examples of different possibilities of installation. Other combinations with equipment from our water play range are possible.

Type of See-saw Pump

Order No. 5.18600

for direct connection to the pressure line

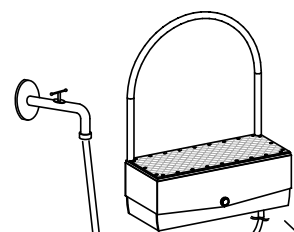

Order No. 5.18700

for water supply from a pond or similar

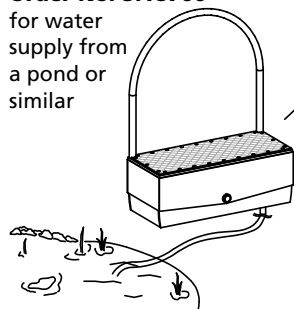

Installation of the Spraying Head

1. on foundation made on site

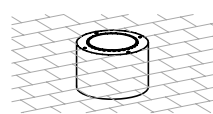

5.18815

2. on Concrete Basin with pump connection **Order No. 5.22000 ff.** see own catalogue sheet

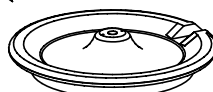

5.18810

5.18835

5.18830

Type of Spraying Head

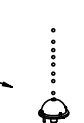
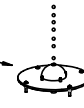

Installation information

reinforced surface

When planning the installation, ensure the spraying head or a similar outlet (e. g. rock fountain) is located at a level higher than the See-Saw-Pump. Otherwise water will run through permanently.

Foundations
1 item 92 x 42 x 80 cm
excavation depth below frost level, but minimum 80 cm

Attention:
Exact measurements may vary, for all installation dimensions refer to current installation instructions.
Technical changes reserved.
For use in chlorine water the equipment is also available with a special steel alloy.

Individual solutions for the water supply must be devised, depending on the plans. Up-to-date details on the connection for the water supply and other technical information is available to download as a table at our website www.richter-spielgeraete.de. Go to "Products" and then to the applicable piece of equipment.

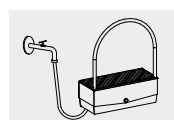

5.18600



5.18700

For more detailed explanation of the quality characteristics see price list.